

QUIL CEDA

105TH STREET NE

EXPANDED SITE PLAN
SCALE 1" = 60'

OWNER
THE TULALIP TRIBES
8802 27TH AVE NE
TULALIP, WA 98271

OWNERS REP
NICK GOBIN
360-716-5025
NGOBIN@TULALIPTRIBES-NSN.GOV

PROJECT ENGINEER
FRED MCDONALD
360-716-5057
FMCDONALD@TULALIPTRIBES-NSN.GOV

WATER AND SEWER
QUIL CEDA VILLAGE UTILITIES
TOM GOBIN
LUCAS REYES
425-754-0418
425-232-4435

COMMUNICATIONS
TULALIP DATA SERVICES
TRAVIS HILL
360-716-5128
THILL@TULALIPTRIBES-NSN.GOV

POWER
DORY ROANHORSE
360-716-5059
DROANHORSE@TULALIPTRIBES-NSN.GOV

NATURAL GAS
PSE
PATTY NESS
360-653-2160 EXT. 105
PATTI.NESS@PSE.COM

QCY MAINTENANCE
CURTIS TAYLOR
360-654-3619

TULALIP BROADBAND
RICHARD BROWN
360-716-3277
RBROWN@TULALIPTRIBES-NSN.GOV

NOTE
DIAL-BEFORE-YOU DIG DOES NOT
PERFORM A COMPLETE LOCATE SERVICE.

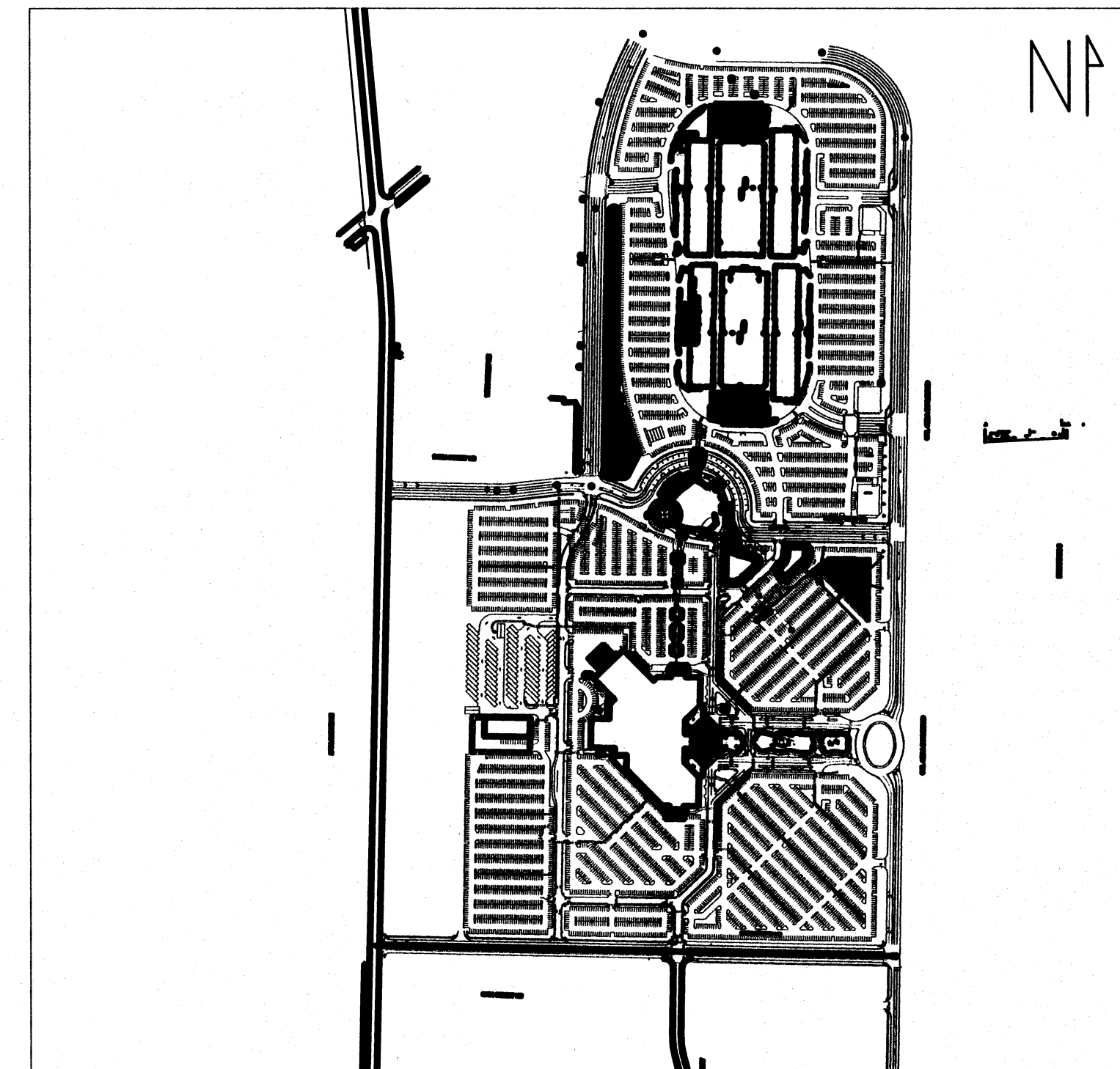

VICINITY MAP
NOT TO SCALE

TABLE OF CONTENTS

- CV - COVER SHEET
- C1.0 - GENERAL NOTES
- C1.1 - EXISTING CONDITIONS & DEMO
- C1.2 - EXISTING CONDITIONS & DEMO
- C2.0 - WATER AND SEWER
- C2.1 - SEWER DETAILS
- C2.2 - WATER DETAILS
- C3.0 - UTILITY TRENCH - ROAD SIDE
- C3.1 - UTILITY TRENCH - PARKING LOT
- C3.2 - UTILITY TRENCH DETAILS
- C3.3 - UTILITY TRENCH DETAILS

REV NO	DESCRIPTION
1	06/04/2010 PRC COMMENTS
-	04/15/2010 PLANS ISSUED

DESIGNED BY
F. MCDONALD

CHK: DRAWN: C.H.

ISSUE DATE
06/04/2010

PROJECT NO.
QCY-CP-10-0003

6/14/2010



RESTAURANT UTILITIES
COVER SHEET

CV

NAV 29
DATUM
NAD 83 (WASHINGTON STATE PLANE GRID POINT)